

DOT Roadside Inspection Guide

Verizon Connect LogBook
ELD version

Viewing a Driver's Hours of Service Log

The Verizon Connect Reveal LogBook solution is designed to help support law enforcement by providing easy and immediate access to driver's current and previous 7 days of historical driver log information which is required to complete an inspection. Drivers need to enable the inspector mode before starting the inspection.

Click **Forward** and **Back** icons () next to the Date to navigate between the past 7 days. In the header of the LogBook Driver Status Log, you can review the standard Hours of Service (HOS) data elements for the driver, including total time spent in each status, daily mileage, and daily and cycle on-duty hourly totals.



Driver View

In the Driver View, you can review the driver details including Driver Name, Carrier Name, US DOT number and driver's license number.



Graph View

In the Graph view, you can review the standard HOS graph grid as would appear on a paper driver log copy. If used by the driver, special driving conditions will be displayed with a white dotted line in the legend.



Log View

In the Log view, you can review status changes, diagnostics events and unidentified miles associated with the connected vehicle. To view more details about an event including event code, event record status, trailer # and shipping reference annotations, tap the icon on the right of the entry.

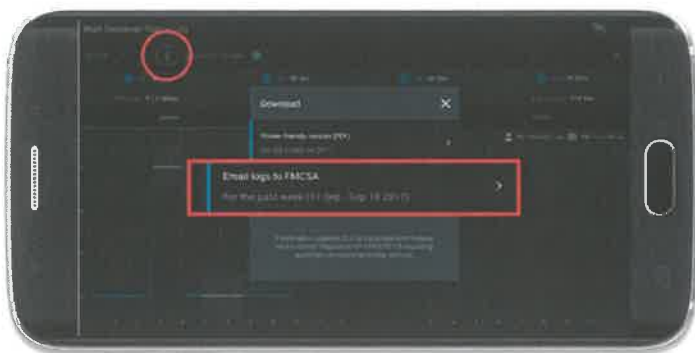

Download

Click on the icon to either print a PDF version or email/web-transfer the HOS logs for the past 8 days. Enter the routing code provided by the DOT inspector in the Comment field during Log submission. The logs will be sent to the default email provided by FMCSA.

About Verizon Connect Reveal LogBook

Verizon Connect Reveal LogBook collects GPS location, vehicle movement, and ECM elements, including speed and odometer, from the vehicle and transmits this information via Bluetooth connection to the proprietary LogBook driver application.

